



Tiny Home FAMILY

Facade:



Facade 2:



Layout:

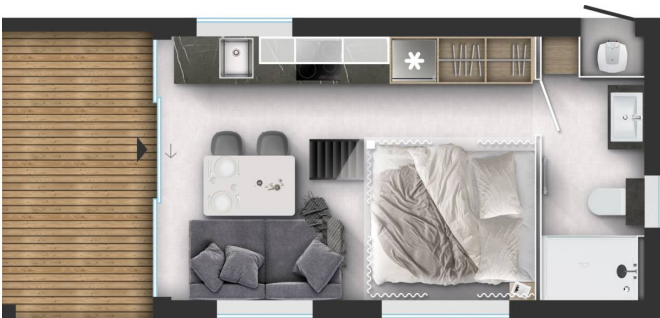

Layout 2:



A1 GENERAL

Area	34,00
Number of beds	4+1
Number of bedrooms	2
Number of bathrooms	1
Height	4,00
Length	8,50
Width	4,00

B1 CHASSIS

100% galvanised steel tube 100/100/5 mm with leveling feet	X, DVE CEVI POD ENOTO, NA SREDINI 2 PROFILA KOT OPORTA
--	--

B2 FLOOR

Vynil flooring	X
Bitumen floor protection	X
Structural Insulated Panels SIP Floor 175mm (R=4,42 m2K/W)	X

B3 EXTERIOR WALLS

Structural Insulated panels SIP 175mm (R=4,42 m2K/W)	X
Decorative attic: Compact - matching colour of windows and doors	X
Decorative Cladding: Larchwood Blackline vertical	X
Other Three Sides: Larchwood Blackline vertical	X

B4 WINDOWS AND DOORS

Tinted windows in bathrooms	X
External installation of windows and doors	X
Interior wooden window trim	X
PVC windows and doors with termopan glass - anthracite outside and inside (U=1,3 W/m2K)	X
Panoramic sliding entrance door with security glass	X
Mosquito nets on all windows - anthracite	X
Master cylinder	X
Window vents in all rooms	X

B5 ROOF AND CEILING

Duo-pitched Roof	X, SIP 175 MM
Roof construction class C (250 kg/m ²)	X
Roof plates Vestis RAL 7016 Stucco	TRAPEZ T35 - ANTRACIT
Gutters	X
Vertical draining pipes - matching colour of windows and doors	X

C0 INTERIOR

Furnishing Decor - STANDARD	FOREST 2022
Textile Combination - STANDARD	FOREST 2022
Interior doors 40 mm with ALU doorframes	X
Door stopper	X
Soft close for furniture	X
Double interior separation walls	X
Bathroom and toilet door with lock	X
Pull-out metal ladder	X, RAL 9005
Metal doorhooks in black colour	X
Metal fence on mansard	X
Furniture handles in black	X
Internal skirtings	X, SMREKA - AQUAVITA BRUSH HRAST 358
Inner cladding for walls	X

C1 LIVING ROOM

Hangers in living room (2 pcs)	X
Wardrobe in living room	X
Electrical sockets in living room (2x)	X
Built-in ceiling spot LED lights in living room with 2-way switch	X

C2 KITCHEN

Glass ceramic hob with 4 burners	X
Built-in extractor hood	X
Granite sink without drainer	X
Built-in fridge with freezer	X
Pre-preparation of installations for built-in dishwasher	X

Electrical sockets over the kitchen counter (2x)	X
LED lightning above kitchen counter	X

C3 MASTER BEDROOM

Double bed with slatted bed base	160 X 200
Foam mattresses (25 kg/m ²) in master bedroom	X
Upholstered bed in master bedroom	X
Wooden headboard in master bedroom	X, LINERIO
Bedside tables in master bedroom	X
Reading LED lights in master bedroom	X
Electrical sockets in master bedroom (2x)	X

C4 CHILDREN BEDROOM

Single beds with slatted bed base	160 X 200
Foam mattresses PN25 in children's bedroom	X
Wooden bed upholstery in children's bedroom	X
Reading LED lights in children's bedroom	X
Electrical socket in children's bedroom	X

C6 BATHROOM

Shower cabin with low profile tray and decorative PVC shower wall	X
Shower rail with sliding shower holder	X
Shower decorative PVC wall	X
Wash-stand with two drawers and mixer tap	X
Mirror in bathroom 1	X
Extra shelves in bathroom	X
Toilet roll holder	X
Hangers in bathroom (2 pcs)	X
Built-in toilet tank with saving function	X, OBLOGA KERADECCO
Built-in ceiling spot LED lights in bathroom	X
Electrical socket in bathroom	X

D1 WATER AND GAS

External connector to water facilities with pressure regulator	X
PVC water pipes Speedfit®	X

Internal access to water heater - door with lock	X, ZUNANJI DOSTOP DO GRELCA VODE
Electrical water heater 100l	X
Insulated water pipes with electrical heating according to EnEV	X

D2 ELECTRICITY

External connection 1 x 32A, 1P+N+E	X
Black flush installations, sockets and switches	X
Ambiental LED lightning in living room and sleeping rooms	X
TV socket	X

D4 HEATING AND COOLING

Preinstallation for Airconditioning in living room	X
Electrical towel heater in bathroom 1	X, (?RN) 3421 00005 001

E1 EXTERIOR EQUIPMENT

Awning LED light	X
External socket - matching colour of windows and doors	X
Canopy over entrance	X, STEKLEN
Terrace larchwood at entrance	X

Legal Notice

The information on this website is provided "as is" and without warranty of any kind, expressed or implied, including (but not limited to) any implied warranties of merchantability and non-infringement of third party rights. While the information provided is believed to be accurate, it may include errors or inaccuracies. In no event shall Adria Home be liable to any person for any special, indirect or consequential damages relating to this material, unless caused by gross negligence or intentional misconduct. The purpose of this website is illustrative. The website may show visuals which may include some elements not belonging to the standard equipment or portray products which may not be available in all markets. Products may change in terms of technical specification and commercial details and in relation to specific regulations. You are advised to always contact your selected Adria representative to obtain all detailed information prior to purchasing.

Copyright

Copyright© Adria Home Ltd., Črnomelj, Slovenia 2024/2025. All rights reserved. The text, images, graphics, sound files, animation files, video files, and their arrangement on the Adria Home website are all subject to copyright and other intellectual property protection. These objects may not be copied for commercial use or distribution, nor may these objects be modified or reposted to other sites. Adria Home website may contain images whose copyrights are attributable to third parties.

Adria Home Ltd.
Kanižarica 135, SI-8340 Črnomelj, Slovenija,
+386 (0) 7 35 69 100
info@adria-home.com

adria-home.com

#adriahome
#adriaglamping

